

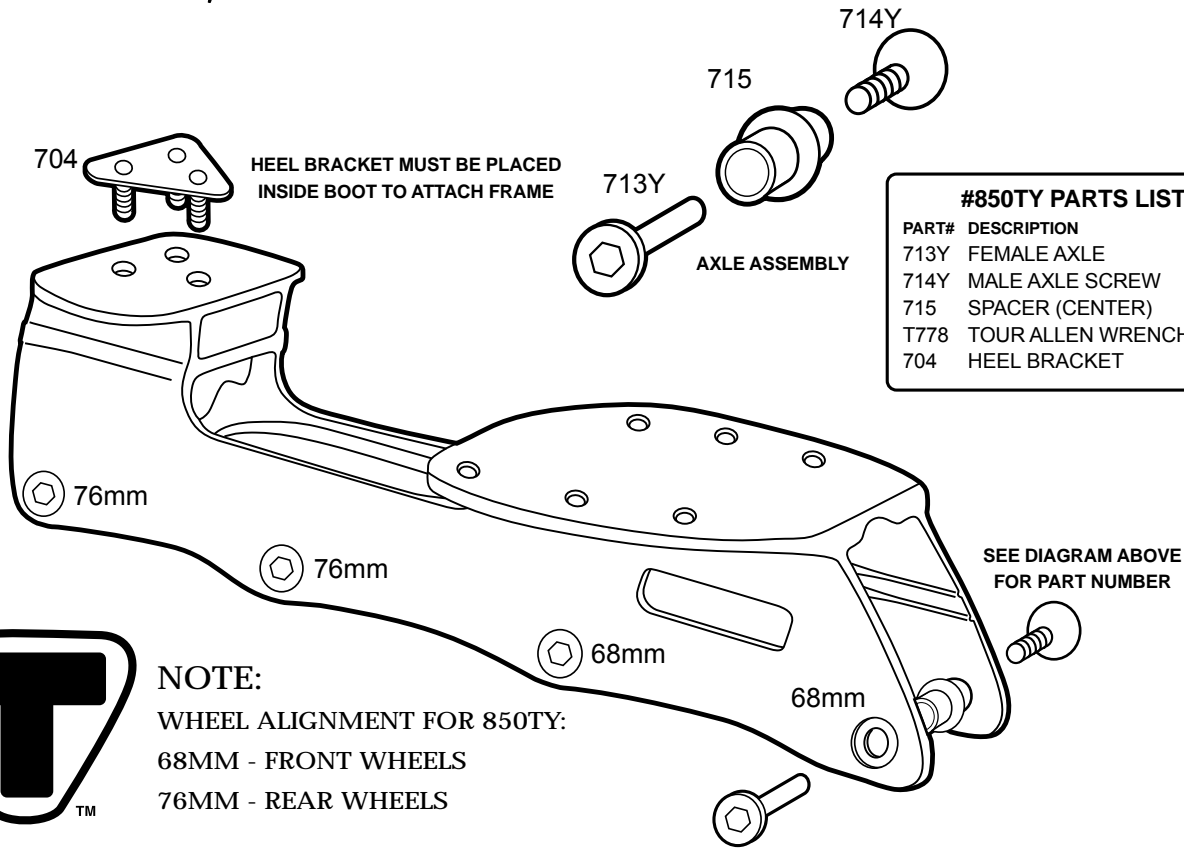

BI-LEVEL - MODEL# 850TY
 YOUTH SIZES 2-4



#850TY PARTS LIST		
PART#	DESCRIPTION	PRICE
713Y	FEMALE AXLE	1.50
714Y	MALE AXLE SCREW	0.70
715	SPACER (CENTER)	.65
T778	TOUR ALLEN WRENCH	2.00
704	HEEL BRACKET	2.50

TOUR HOCKEY • 311 W. EDWARDS ST. • LITCHFIELD, IL 62056 • FAX (217) 324-2213
 WARRANTY: 120 days from purchase date. Defective parts must be returned to TOUR, along with original sales receipt, TOUR HOCKEY reserves the right to repair or replace defective parts. Due to the nature of the sport, bent frames are not considered to be defective.

TOUR BI-LEVEL YOUTH FRAME PARTS ORDER

Orders must be mailed or faxed to Tour Hockey (NO PHONE ORDERS ACCEPTED)
 TOUR HOCKEY • 311 W. Edwards St. • Litchfield, IL 62056 • Fax 217-324-2213
 We recommend that you check with your local dealer before ordering from TOUR.

ITEM#	DESCRIPTION	COST (ea)	QUANTITY	TOTAL
713Y	FEMALE AXLE	1.50		
714Y	MALE AXLE SCREW	.70		
715	SPACER (CENTER)	.65		
T778	TOUR ALLEN WRENCH	2.00		
BH6878WR	68MM GRIPPER WHEEL	5.00		
BH7678WR	76MM GRIPPER WHEEL	5.00		
704	HEEL MOUNTING BRACKET	2.50		

All sales must be paid by check or MasterCard or Visa. Ill.residents add 7.25% sales tax

MC or Visa #: _____ shipping & handling \$6.25

Signature: _____ Exp. Date: _____ TOTAL _____

SHIP TO: _____

Address: _____

City: _____ State: _____ Zip: _____

Phone: _____ Date: _____

Orders must be mailed or faxed (NO PHONE ORDERS ACCEPTED)
 TOUR • 311 W. Edwards St.
 Litchfield, IL 62056 Fax 217-324-2213

•• PLEASE ALLOW 2 TO 4 WEEKS FOR DELIVERY ••