

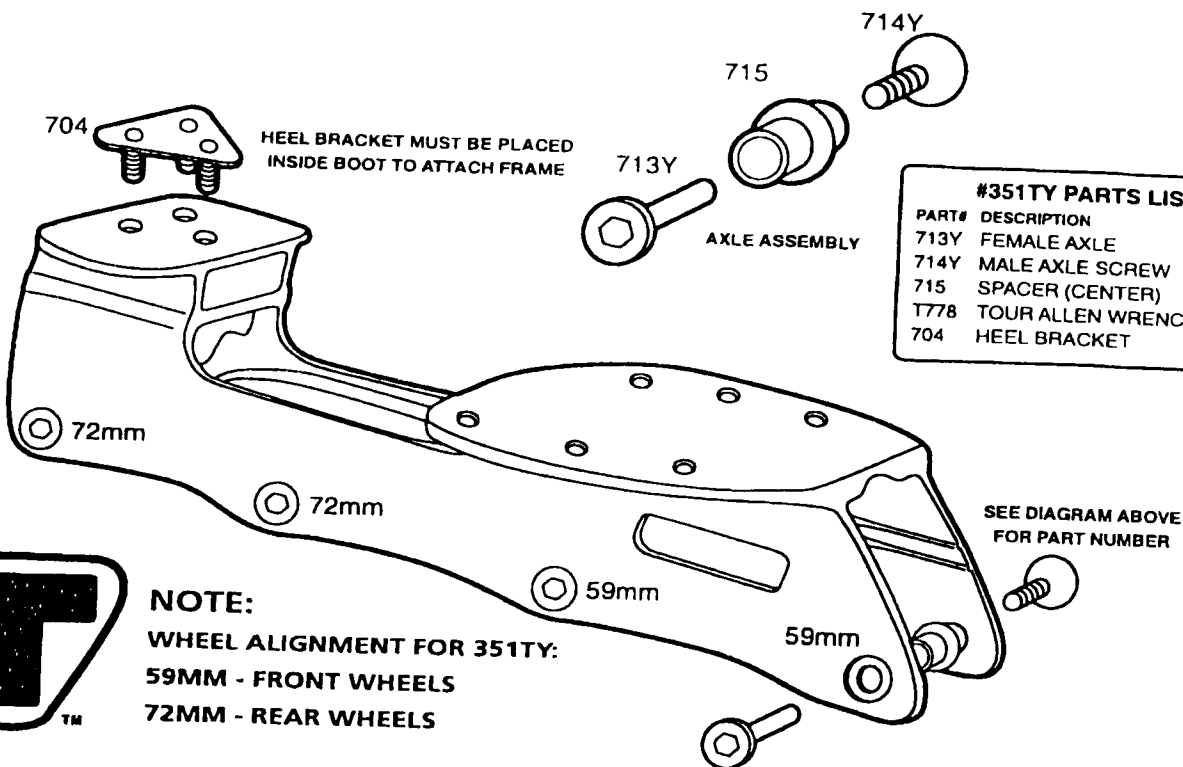

BI-LEVEL - MODEL# 351TY

YOUTH SIZES 12-4



#351TY PARTS LIST		
PART#	DESCRIPTION	PRICE
713Y	FEMALE AXLE	1.50
714Y	MALE AXLE SCREW	0.70
715	SPACER (CENTER)	.65
T778	TOUR ALLEN WRENCH	2.00
704	HEEL BRACKET	2.50

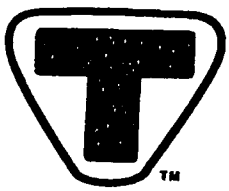

NOTE:
WHEEL ALIGNMENT FOR 351TY:
59MM - FRONT WHEELS
72MM - REAR WHEELS

TOUR HOCKEY • 311 W. EDWARDS ST. • LITCHFIELD, IL 62056 • FAX (217) 324-2213
WARRANTY: 120 days from purchase date. Defective parts must be returned to TOUR, along with original sales receipt, TOUR HOCKEY reserves the right to repair or replace defective parts. Due to the nature of the sport, bent frames are not considered to be defective.

TOUR BI-LEVEL YOUTH FRAME PARTS ORDER

Orders must be mailed or faxed to Tour Hockey (NO PHONE ORDERS ACCEPTED)
TOUR HOCKEY • 311 W. Edwards St. • Litchfield, IL 62056 • Fax 217-324-2213
We recommend that you check with your local dealer before ordering from TOUR.

ITEM#	DESCRIPTION	COST (ea)	QUANTITY	TOTAL
713Y	FEMALE AXLE	1.50		
714Y	MALE AXLE SCREW	.70		
715	SPACER (CENTER)	.65		
T778	TOUR ALLEN WRENCH	2.00		
BH5975WB	59MM INVADER WHEEL	3.00		
BH7275WB	72MM INVADER WHEEL	4.00		
704	HEEL MOUNTING BRACKET	2.50		
717	FRAME SPACER	.50		
718	SPACER SCREW	.25		

All sales must be paid by check or MasterCard or Visa.

MC or Visa #: _____
Signature: _____ Exp. Date: _____
SHIP TO: _____
Address: _____
City: _____ State: _____ Zip: _____
Phone: _____ Date: _____

Ill. residents add 6.25% sales tax
6.75

shipping & handling

TOTAL

6.25	53.00
TOTAL	

Orders must be mailed or faxed
(NO PHONE ORDERS ACCEPTED)
TOUR • 311 W. Edwards St.
Litchfield, IL 62056 Fax 217-324-2213

•• PLEASE ALLOW 2 TO 4 WEEKS FOR DELIVERY ••